

+105°C Tubular Radial Lead Aluminum Capacitors

Features-

- Wide Temperature Range
- Long Life
- Two and Three Leaded Radial Designs

General Specifications-

Operating Temperature:

-55 to +105°C

Voltage Range:

6.3 – 250 VDC

Capacitance Range:

12µF to 33,000µF

Capacitance Tolerance:

-10%/+50% (Std.)

Case Size Range:

0.750" X 1.125" – 1.000" X 3.625"

Termination:

Radial Leads

Life Validation Test: 2,000hrs @ +105°C

Δ CAP ≤ 15% From initial measurement.

Δ ESR ≤ 1.5X Initial specified limit.

Δ DCL ≤ Initial specified limit.

Shelf Test: 500hrs @ +105°C

Δ CAP ≤ 10% From initial measurement.

Δ ESR ≤ 1.15X Initial specified limit.

Δ DCL ≤ 2.0X Initial specified limit.

DC Leakage Current: (After 5 min. charge)

$$I = k\sqrt{CV};$$

$$k = 0.5 @ +25°C;$$

Where:

I is in µA

C is in µF

V is in Volts



Ripple Current Multipliers:

Temperature:

Ambient Temp.	Multiplier
+105°C	0.40
+85°C	1.00
+65°C	1.40
+45°C	1.70
+25°C	2.00

Frequency (Hz)

Rated Voltage (VDC)	50 – 60	300 – 400	1k & Up
0 – 60	0.85	1.10	1.15
61 – 250	0.83	1.15	1.20

Low Temperature Performance:

Capacitance Ratio $C^{-55°C}/C^{+25°C}$ min. @ 120Hz.

Rated Voltage (VDC)	Capacitance Remaining
0 – 25	75%
26 – 100	80%
101 – 250	85%

ESR Ratio $ESR^{-55°C}/ESR^{+25°C}$ min. @ 120Hz

Rated Voltage (VDC)	Multiplier
0 – 9	10
10 – 40	12
41 – 100	18
150 – 250	100

PART NUMBER BREAK-DOWN:

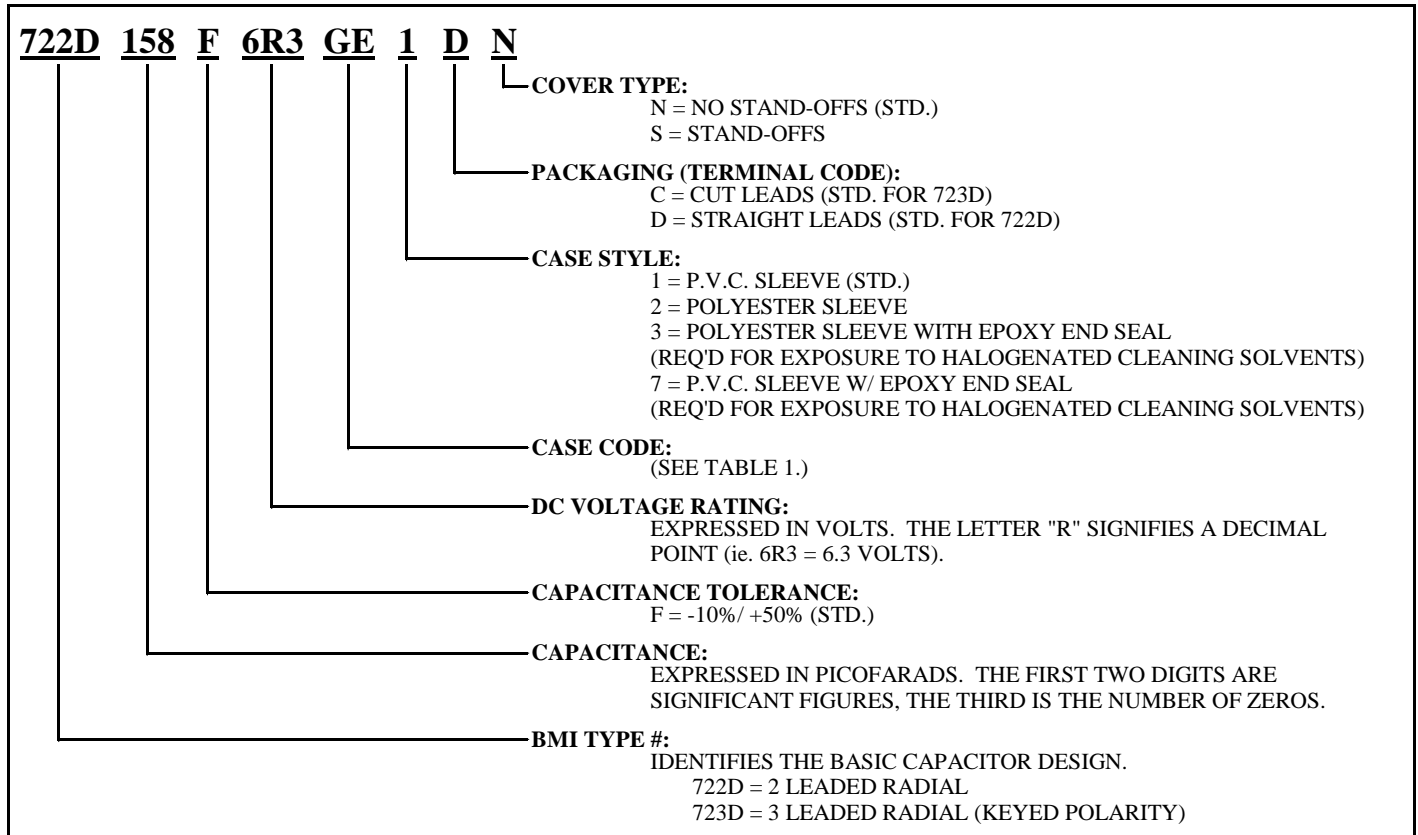

Table 1. Case Dimensions mm(in.)

CASE CODE	NOMINAL		PVC SLEEVING		OUTER INSULATION WITH EPOXY END SEAL		LEAD SPACING*	WIRE GAUGE 'W'
	'D'	'L'	'D' ±0.51(±0.020)	'L' ±1.58(±0.062)	'D' ±0.51(±0.020)	'L' ±1.58(±0.062)	S ±0.38 (±0.015)	
GE	19.05 (0.750)	28.58 (1.125)	19.30 (0.760)	28.98 (1.141)	19.30 (0.760)	30.15 (1.187)	6.35 (0.250)	No. 18 AWG (0.040")
GJ	19.05 (0.750)	41.28 (1.625)	19.30 (0.760)	41.68 (1.641)	19.30 (0.760)	42.85 (1.687)	6.35 (0.250)	No. 18 AWG (0.040")
GL	19.05 (0.750)	53.98 (2.125)	19.30 (0.760)	54.38 (2.141)	19.30 (0.760)	55.55 (2.187)	6.35 (0.250)	No. 18 AWG (0.040")
GP	19.05 (0.750)	66.68 (2.625)	19.30 (0.760)	67.08 (2.641)	19.30 (0.760)	68.25 (2.687)	6.35 (0.250)	No. 18 AWG (0.040")
GS	19.05 (0.750)	79.38 (3.125)	19.30 (0.760)	79.78 (3.141)	19.30 (0.760)	80.95 (3.187)	6.35 (0.250)	No. 18 AWG (0.040")
GT	19.05 (0.750)	92.08 (3.625)	19.30 (0.760)	92.48 (3.641)	19.30 (0.760)	93.65 (3.687)	6.35 (0.250)	No. 18 AWG (0.040")
HE	22.23 (0.875)	28.58 (1.125)	22.48 (0.885)	28.98 (1.141)	22.48 (0.885)	30.15 (1.187)	7.62 (0.300)	No. 18 AWG (0.040")
HJ	22.23 (0.875)	41.28 (1.625)	22.48 (0.885)	41.68 (1.641)	22.48 (0.885)	42.85 (1.687)	7.62 (0.300)	No. 18 AWG (0.040")
HL	22.23 (0.875)	53.98 (2.125)	22.48 (0.885)	54.38 (2.141)	22.48 (0.885)	55.55 (2.187)	7.62 (0.300)	No. 18 AWG (0.040")
HP	22.23 (0.875)	66.68 (2.625)	22.48 (0.885)	67.08 (2.641)	22.48 (0.885)	68.25 (2.687)	7.62 (0.300)	No. 18 AWG (0.040")
HS	22.23 (0.875)	79.38 (3.125)	22.48 (0.885)	79.78 (3.141)	22.48 (0.885)	80.95 (3.187)	7.62 (0.300)	No. 18 AWG (0.040")
HT	22.23 (0.875)	92.08 (3.625)	22.48 (0.885)	92.48 (3.641)	22.48 (0.885)	93.65 (3.687)	7.62 (0.300)	No. 18 AWG (0.040")
JE	25.40 (1.000)	28.58 (1.125)	25.65 (1.010)	28.98 (1.141)	25.65 (1.010)	30.15 (1.187)	10.16 (0.400)	No. 18 AWG (0.040")
JJ	25.40 (1.000)	41.28 (1.625)	25.65 (1.010)	41.68 (1.641)	25.65 (1.010)	42.85 (1.687)	10.16 (0.400)	No. 18 AWG (0.040")
JL	25.40 (1.000)	53.98 (2.125)	25.65 (1.010)	54.38 (2.141)	25.65 (1.010)	55.55 (2.187)	10.16 (0.400)	No. 18 AWG (0.040")
JP	25.40 (1.000)	66.68 (2.625)	25.65 (1.010)	67.08 (2.641)	25.65 (1.010)	68.25 (2.687)	10.16 (0.400)	No. 18 AWG (0.040")
JS	25.40 (1.000)	79.38 (3.125)	25.65 (1.010)	79.78 (3.141)	25.65 (1.010)	80.95 (3.187)	10.16 (0.400)	No. 18 AWG (0.040")
JT	25.40 (1.000)	92.08 (3.625)	25.65 (1.010)	92.48 (3.641)	25.65 (1.010)	93.65 (3.687)	10.16 (0.400)	No. 18 AWG (0.040")

* LEAD SPACING FOR TYPE 722D ONLY. SEE TABLE 2 FOR LEAD SPACING ON 723D SERIES.

Table 2. Lead Spacing Dimensions for Type 723D mm(in.)

CASE DIA.	'A' ±0.40 (±0.015)	'B' ±0.40 (±0.015)	'C' ±0.40 (±0.015)	'C1' ±0.40 (±0.015)
19.05 (0.750)	7.62 (0.300)	4.23 (0.167)	2.54 (0.100)	5.08 (0.200)
22.23 (0.875)	10.16 (0.400)	5.79 (0.228)	3.81 (0.150)	7.62 (0.300)
25.40 (1.000)	10.16 (0.400)	5.79 (0.228)	3.81 (0.150)	7.62 (0.300)

Radial-Leaded Capacitor Dimensions

**TYPE 722D
TERMINAL CODE C**

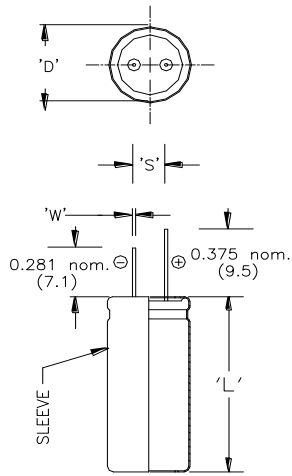

**TYPE 722D
TERMINAL CODE D**

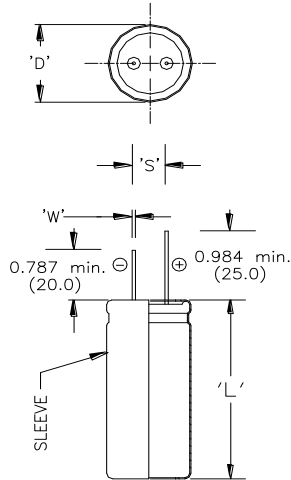

**TYPE 722D
w/ S COVER CODE**

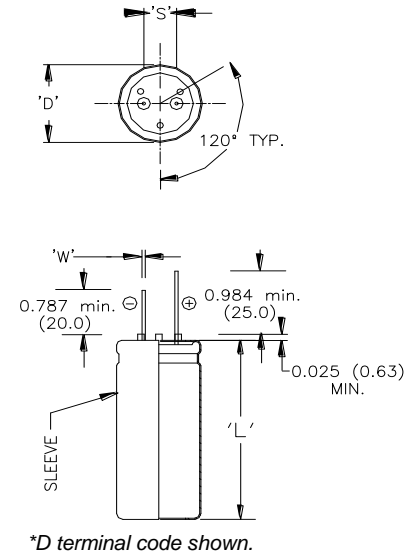

**TYPE 723D
TERMINAL CODE C**

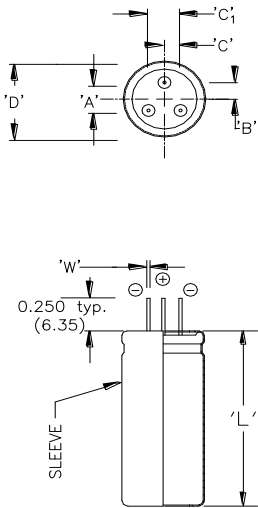

**TYPE 723D
w/ S COVER CODE**

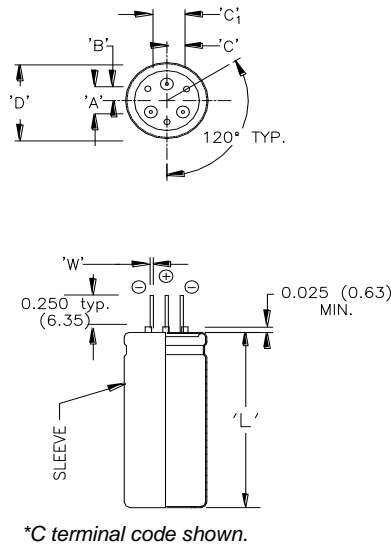

**TYPE 723D
w/ EPOXY END-SEAL**

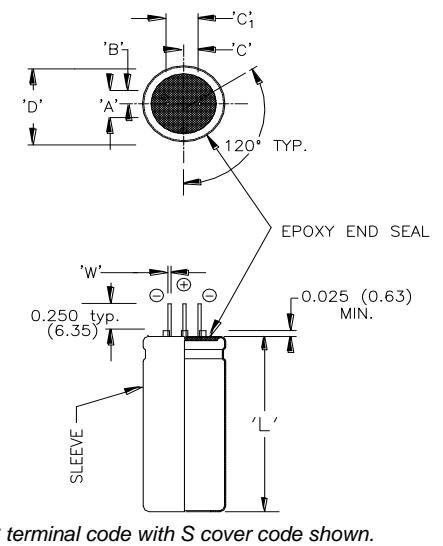

Other terminal configurations may be available upon request. For inquiries please contact your BMI Sales representative.

STANDARD RATINGS FOR TYPE 722D/723D

Rated Capacitance (μ F)	Catalog Number	Nominal Case Size (D x L) (in.)	Maximum ESR +25°C 120Hz (Ω)	Maximum ESR +25°C 20-100kHz (Ω)	Max. Ripple Current +85°C 120Hz (Arms)	Max. Ripple Current +85°C 20-100kHz (Arms)
6.3 VOLTS DC WORKING; 8 VOLTS DC SURGE						
2,700	722D278F6R3GE1	0.750 x 1.125	0.169	0.124	1.58	1.84
5,600	722D568F6R3GJ1	0.750 x 1.625	0.083	0.061	2.60	3.02
8,200	722D828F6R3GL1	0.750 x 2.125	0.057	0.042	3.52	4.07
10,000	722D109F6R3GP1	0.750 x 2.625	0.043	0.032	4.40	5.09
12,000	722D129F6R3GS1	0.750 x 3.125	0.037	0.028	5.13	5.91
15,000	722D159F6R3GT1	0.750 x 3.625	0.031	0.023	5.98	6.89
3,900	722D398F6R3HE1	0.875 x 1.125	0.118	0.088	2.09	2.42
8,200	722D828F6R3HJ1	0.875 x 1.625	0.059	0.044	3.38	3.90
12,000	722D129F6R3HL1	0.875 x 2.125	0.042	0.031	4.47	5.15
15,000	722D159F6R3HP1	0.875 x 2.625	0.033	0.024	5.54	6.37
18,000	722D189F6R3HS1	0.875 x 3.125	0.027	0.020	6.56	7.50
22,000	722D229F6R3HT1	0.875 x 3.625	0.023	0.018	7.52	8.61
5,600	722D568F6R3JE1	1.000 x 1.125	0.093	0.069	2.57	2.96
10,000	722D109F6R3JJ1	1.000 x 1.625	0.049	0.036	4.05	4.66
18,000	722D189F6R3JL1	1.000 x 2.125	0.033	0.025	5.44	6.23
22,000	722D229F6R3JP1	1.000 x 2.625	0.026	0.020	6.72	7.68
27,000	722D279F6R3JS1	1.000 x 3.125	0.022	0.017	7.86	8.91
33,000	722D339F6R3JT1	1.000 x 3.625	0.019	0.015	8.98	10.18
10 VOLTS DC WORKING; 15 VOLTS DC SURGE						
2,200	722D228F010GE1	0.750 x 1.125	0.182	0.129	1.53	1.81
3,900	722D398F010GJ1	0.750 x 1.625	0.091	0.065	2.50	2.96
6,800	722D688F010GL1	0.750 x 2.125	0.061	0.044	3.40	4.03
8,200	722D828F010GP1	0.750 x 2.625	0.047	0.034	4.25	5.01
10,000	722D109F010GS1	0.750 x 3.125	0.041	0.029	5.00	5.82
12,000	722D129F010GT1	0.750 x 3.625	0.035	0.025	5.72	6.71
3,300	722D338F010HE1	0.875 x 1.125	0.127	0.090	2.02	2.39
5,600	722D568F010HJ1	0.875 x 1.625	0.064	0.046	3.26	3.84
8,200	722D828F010HL1	0.875 x 2.125	0.044	0.032	4.38	5.14
12,000	722D129F010HP1	0.875 x 2.625	0.036	0.026	5.30	6.22
15,000	722D159F010HS1	0.875 x 3.125	0.029	0.020	6.43	7.50
18,000	722D189F010HT1	0.875 x 3.625	0.025	0.018	7.37	8.56
3,900	722D398F010JE1	1.000 x 1.125	0.099	0.071	2.49	2.93
8,200	722D828F010JJ1	1.000 x 1.625	0.050	0.037	4.00	4.67
13,000	722D139F010JL1	1.000 x 2.125	0.036	0.026	5.27	6.15
18,000	722D189F010JP1	1.000 x 2.625	0.028	0.021	6.45	7.49
22,000	722D229F010JS1	1.000 x 3.125	0.023	0.017	7.68	8.86
27,000	722D279F010JT1	1.000 x 3.625	0.020	0.015	8.75	10.1
16 VOLTS DC WORKING; 20 VOLTS DC SURGE						
1,500	722D158F016GE1	0.750 x 1.125	0.198	0.132	1.47	1.79
3,300	722D338F016GJ1	0.750 x 1.625	0.098	0.066	2.40	2.92
4,700	722D478F016GL1	0.750 x 2.125	0.067	0.045	3.26	3.95
5,600	722D568F016GP1	0.750 x 2.625	0.051	0.035	4.07	4.93
8,200	722D828F016GS1	0.750 x 3.125	0.042	0.029	4.87	5.86
10,000	722D109F016GT1	0.750 x 3.625	0.036	0.025	5.64	6.78
2,200	722D228F016HE1	0.875 x 1.125	0.139	0.094	1.93	2.34

STANDARD RATINGS FOR TYPE 722D/723D

Rated Capacitance (μ F)	Catalog Number	Nominal Case Size (D x L) (in.)	Maximum ESR +25°C 120Hz (Ω)	Maximum ESR +25°C 20-100kHz (Ω)	Max. Ripple Current +85°C 120Hz (Arms)	Max. Ripple Current +85°C 20-100kHz (Arms)
16 VOLTS DC WORKING; 20 VOLTS DC SURGE (CONTINUED)						
4,700	722D478F016HJ1	0.875 x 1.625	0.070	0.048	3.12	3.77
6,800	722D688F016HL1	0.875 x 2.125	0.048	0.033	4.20	5.05
10,000	722D109F016HP1	0.875 x 2.625	0.037	0.026	5.23	6.27
12,000	722D129F016HS1	0.875 x 3.125	0.031	0.022	6.19	7.38
15,000	722D159F016HT1	0.875 x 3.625	0.027	0.019	7.06	8.40
3,300	722D338F016JE1	1.000 x 1.125	0.108	0.075	2.38	2.87
6,800	722D688F016JJ1	1.000 x 1.625	0.055	0.038	3.83	4.59
10,000	722D109F016JL1	1.000 x 2.125	0.038	0.027	5.10	6.09
25 VOLTS DC WORKING; 40 VOLTS DC SURGE						
1,000	722D108F025GE1	0.750 x 1.125	0.213	0.134	1.41	1.78
1,800	722D188F025GJ1	0.750 x 1.625	0.110	0.070	2.27	2.85
2,700	722D278F025GL1	0.750 x 2.125	0.073	0.047	3.11	3.89
3,900	722D398F025GP1	0.750 x 2.625	0.056	0.036	3.91	4.87
4,700	722D478F025GS1	0.750 x 3.125	0.045	0.029	4.68	5.80
5,600	722D568F025GT1	0.750 x 3.625	0.038	0.025	5.43	6.70
1,500	722D158F025HE1	0.875 x 1.125	0.157	0.100	1.81	2.27
2,700	722D278F025HJ1	0.875 x 1.625	0.076	0.049	2.98	3.72
3,900	722D398F025HL1	0.875 x 2.125	0.052	0.034	4.04	5.01
5,600	722D568F025HP1	0.875 x 2.625	0.040	0.026	5.04	6.20
6,800	722D688F025HS1	0.875 x 3.125	0.033	0.022	6.00	7.33
8,200	722D828F025HT1	0.875 x 3.625	0.028	0.019	6.91	8.42
1,800	722D188F025JE1	1.000 x 1.125	0.117	0.076	2.28	2.83
3,900	722D398F025JJ1	1.000 x 1.625	0.059	0.039	3.70	4.55
5,600	722D568F025JL1	1.000 x 2.125	0.040	0.027	4.96	6.07
8,200	722D828F025JP1	1.000 x 2.625	0.031	0.021	6.14	7.44
10,000	722D109F025JS1	1.000 x 3.125	0.027	0.018	7.15	8.64
12,000	722D129F025JT1	1.000 x 3.625	0.023	0.016	8.21	9.89
35 VOLTS DC WORKING; 50 VOLTS DC SURGE						
680	722D687F035GE1	0.750 x 1.125	0.266	0.137	1.26	1.75
1,200	722D128F035GJ1	0.750 x 1.625	0.133	0.070	2.06	2.84
2,200	722D228F035GL1	0.750 x 2.125	0.087	0.046	2.84	3.89
2,700	722D278F035GP1	0.750 x 2.625	0.068	0.036	3.52	4.8
3,300	722D338F035GS1	0.750 x 3.125	0.054	0.025	4.25	5.75
3,900	722D398F035GT1	0.750 x 3.625	0.046	0.025	4.95	6.67
1,000	722D108F035HE1	0.875 x 1.125	0.182	0.096	1.68	2.31
2,200	722D228F035HJ1	0.875 x 1.625	0.091	0.049	2.73	3.72
2,700	722D278F035HL1	0.875 x 2.125	0.062	0.034	3.67	4.94
3,900	722D398F035HP1	0.875 x 2.625	0.047	0.026	4.61	6.17
4,700	722D478F035HS1	0.875 x 3.125	0.039	0.022	5.46	7.26
5,600	722D568F035HT1	0.875 x 3.625	0.033	0.019	6.33	8.35
1,200	722D128F035JE1	1.000 x 1.125	0.146	0.079	2.04	2.77
2,700	722D278F035JJ1	1.000 x 1.625	0.071	0.039	3.35	4.49
3,900	722D398F035JL1	1.000 x 2.125	0.048	0.027	4.52	5.99
5,600	722D568F035JP1	1.000 x 2.625	0.037	0.021	5.62	7.37
6,800	722D688F035JS1	1.000 x 3.125	0.030	0.018	6.66	8.67
8,200	722D828F035JT1	1.000 x 3.625	0.026	0.015	7.66	9.92

STANDARD RATINGS FOR TYPE 722D/723D

Rated Capacitance (μ F)	Catalog Number	Nominal Case Size (D x L) (in.)	Maximum ESR +25°C 120Hz (Ω)	Maximum ESR +25°C 20-100kHz (Ω)	Max. Ripple Current +85°C 120Hz (Arms)	Max. Ripple Current +85°C 20-100kHz (Arms)
50 VOLTS DC WORKING; 75 VOLTS DC SURGE						
470	722D477F050GE1	0.750 x 1.125	0.285	0.135	1.22	1.77
1,000	722D108F050GJ1	0.750 x 1.625	0.139	0.067	2.02	2.90
1,500	722D158F050GL1	0.750 x 2.125	0.095	0.047	2.73	3.90
1,800	722D188F050GP1	0.750 x 2.625	0.071	0.035	3.45	4.90
2,200	722D228F050GS1	0.750 x 3.125	0.060	0.030	4.08	5.75
2,700	722D278F050GT1	0.750 x 3.625	0.050	0.025	4.76	6.67
680	722D687F050HE1	0.875 x 1.125	0.196	0.095	1.62	2.32
1,500	722D158F050HJ1	0.875 x 1.625	0.099	0.049	2.63	3.72
2,200	722D228F050HL1	0.875 x 2.125	0.067	0.034	3.55	4.99
2,700	722D278F050HP1	0.875 x 2.625	0.051	0.027	4.44	6.17
3,300	722D338F050HS1	0.875 x 3.125	0.042	0.022	5.28	7.29
3,900	722D398F050HT1	0.875 x 3.625	0.036	0.019	6.12	8.38
1,000	722D108F050JE1	1.000 x 1.125	0.148	0.075	2.03	2.86
1,800	722D188F050JJ1	1.000 x 1.625	0.077	0.040	3.23	4.50
2,700	722D278F050JL1	1.000 x 2.125	0.052	0.028	4.37	6.00
3,900	722D398F050JP1	1.000 x 2.625	0.040	0.022	5.44	7.40
4,700	722D478F050JS1	1.000 x 3.125	0.033	0.018	6.47	8.69
5,600	722D568F050JT1	1.000 x 3.625	0.028	0.016	7.45	9.92
63 VOLTS DC WORKING; 90 VOLTS DC SURGE						
390	722D397F063GE1	0.750 x 1.125	0.304	0.138	1.18	1.75
820	722D827F063GJ1	0.750 x 1.625	0.150	0.069	1.94	2.86
1,200	722D128F063GL1	0.750 x 2.125	0.105	0.049	2.59	3.79
1,500	722D158F063GP1	0.750 x 2.625	0.080	0.038	3.26	4.73
1,800	722D188F063GS1	0.750 x 3.125	0.062	0.030	3.99	5.75
2,200	722D228F063GT1	0.750 x 3.625	0.053	0.026	4.62	6.62
680	722D687F063HE1	0.875 x 1.125	0.210	0.098	1.57	2.30
1,200	722D128G063HJ1	0.875 x 1.625	0.109	0.052	2.50	3.63
1,800	722D188F063HL1	0.875 x 2.125	0.070	0.034	3.47	4.97
2,200	722D228F063HP1	0.875 x 2.625	0.054	0.027	4.31	6.13
2,700	722D278F063HS1	0.875 x 3.125	0.045	0.023	5.12	7.21
3,900	722D398F063HT1	0.875 x 3.625	0.038	0.019	5.98	8.33
820	722D827F063JE1	1.000 x 1.125	0.158	0.076	1.97	2.83
1,800	722D188F063JJ1	1.000 x 1.625	0.081	0.040	3.14	4.46
2,700	722D278F063JL1	1.000 x 2.125	0.055	0.028	4.25	5.97
3,300	722D338F063JP1	1.000 x 2.625	0.042	0.022	5.31	7.35
3,900	722D398F063JS1	1.000 x 3.125	0.034	0.018	6.31	8.64
4,700	722D478F063JT1	1.000 x 3.625	0.029	0.016	7.29	9.89
100 VOLTS DC WORKING; 150 VOLTS DC SURGE						
120	722D127F100GE1	0.750 x 1.125	0.986	0.421	0.66	1.00
270	722D277F100GJ1	0.750 x 1.625	0.461	0.198	1.11	1.69
390	722D387F100GL1	0.750 x 2.125	0.302	0.131	1.53	2.33
470	722D477F100GP1	0.750 x 2.625	0.230	0.100	1.92	2.91
560	722D567F100GS1	0.750 x 3.125	0.183	0.080	2.33	3.52
680	722D687F100GT1	0.750 x 3.625	0.152	0.067	2.73	4.11
180	722D187F100HE1	0.875 x 1.125	0.632	0.273	0.90	1.38
390	722D397F100HJ1	0.875 x 1.625	0.308	0.134	1.49	2.25

STANDARD RATINGS FOR TYPE 722D/723D

Rated Capacitance (μ F)	Catalog Number	Nominal Case Size (D x L) (in.)	Maximum ESR +25°C 120Hz (Ω)	Maximum ESR +25°C 20-100kHz (Ω)	Max. Ripple Current +85°C 120Hz (Arms)	Max. Ripple Current +85°C 20-100kHz (Arms)
100 VOLTS DC WORKING; 150 VOLTS DC SURGE (CONTINUED)						
560	722D567F100HL1	0.875 x 2.125	0.205	0.090	2.03	3.06
680	722D687F100HP1	0.875 x 2.625	0.155	0.068	2.56	3.84
820	722D827F100HS1	0.875 x 3.125	0.124	0.056	3.08	4.60
1,000	722D108F100HT1	0.875 x 3.625	0.108	0.048	3.53	5.26
270	722D277F100JE1	1.000 x 1.125	0.469	0.205	1.14	1.73
470	722D477F100JJ1	1.000 x 1.625	0.226	0.100	1.88	2.83
820	722D827F100JL1	1.000 x 2.125	0.152	0.068	2.56	3.82
1,000	722D108F100JP1	1.000 x 2.625	0.120	0.054	3.14	4.67
1,200	722D128F100JS1	1.000 x 3.125	0.093	0.043	3.83	5.66
1,500	722D157F100JT1	1.000 x 3.625	0.081	0.037	4.37	6.45
150 VOLTS DC WORKING; 200 VOLTS DC SURGE						
56	722D566F150GE1	0.750 x 1.125	2.089	0.884	0.45	0.69
100	722D107F150GJ1	0.750 x 1.625	1.033	0.438	0.74	1.14
150	722D157F150GL1	0.750 x 2.125	0.683	0.291	1.02	1.56
220	722D227F150GP1	0.750 x 2.625	0.511	0.218	1.29	1.97
270	722D277F150GS1	0.750 x 3.125	0.409	0.175	1.56	2.38
330	722D337F150GT1	0.750 x 3.625	0.341	0.146	1.82	2.78
82	722D826F150HE1	0.875 x 1.125	1.395	0.593	0.61	0.93
150	722D157F150HJ1	0.875 x 1.625	0.695	0.297	0.99	1.51
270	722D277F150HL1	0.875 x 2.125	0.451	0.193	1.37	2.09
330	722D337F150HP1	0.875 x 2.625	0.345	0.148	1.71	2.61
390	722D397F150HS1	0.875 x 3.125	0.273	0.118	2.08	3.16
470	722D477F150HT1	0.875 x 3.625	0.226	0.098	2.44	3.70
100	722D107F150JE1	1.000 x 1.125	1.082	0.463	0.75	1.15
220	722D227F150JJ1	1.000 x 1.625	0.502	0.216	1.26	1.93
330	722D337F150JL1	1.000 x 2.125	0.328	0.142	1.74	2.64
470	722D477F150JP1	1.000 x 2.625	0.244	0.107	2.20	3.33
560	722D566F150JS1	1.000 x 3.125	0.195	0.086	2.65	4.00
680	722D687F150JT1	1.000 x 3.625	0.165	0.073	3.07	4.63
200 VOLTS DC WORKING; 250 VOLTS DC SURGE						
27	722D276F200FE1	0.625 x 1.125	3.985	1.501	0.29	0.48
56	722D566F200FJ1	0.625 x 1.625	1.892	0.714	0.49	0.80
82	722D826F200FL1	0.625 x 2.125	1.242	0.469	0.68	1.11
100	722D107F200FP1	0.625 x 2.625	0.925	0.350	0.86	1.41
120	722D127F200FS1	0.625 x 3.125	0.761	0.288	1.03	1.67
150	722D157F200FT1	0.625 x 3.625	0.651	0.248	1.19	1.94
47	722D476F200GE1	0.750 x 1.125	2.354	0.889	0.42	0.69
82	722D826F200GJ1	0.750 x 1.625	1.142	0.433	0.70	1.14
120	722D127F200GL1	0.750 x 2.125	0.774	0.294	0.95	1.55
180	722D187F200GP1	0.750 x 2.625	0.578	0.220	1.21	1.96
220	722D227F200GS1	0.750 x 3.125	0.462	0.176	1.46	2.37
270	722D277F200GT1	0.750 x 3.625	0.385	0.147	1.71	2.77
120	722D127F200HJ1	0.875 x 1.625	0.787	0.300	0.93	1.51
180	722D187F200HL1	0.875 x 2.125	0.521	0.199	1.27	2.06
270	722D277F200HP1	0.875 x 2.625	0.390	0.150	1.61	2.59
330	722D337F200HS1	0.875 x 3.125	0.302	0.117	1.97	3.17

STANDARD RATINGS FOR TYPE 722D/723D

Rated Capacitance (μ F)	Catalog Number	Nominal Case Size (D x L) (in.)	Maximum ESR +25°C 120Hz (Ω)	Maximum ESR +25°C 20-100kHz (Ω)	Max. Ripple Current +85°C 120Hz (Arms)	Max. Ripple Current +85°C 20-100kHz (Arms)
200 VOLTS DC WORKING; 250 VOLTS DC SURGE (CONTINUED)						
390	722D397F200HT1	0.875 x 3.625	0.254	0.098	2.30	3.69
82	722D826F200JE1	1.000 x 1.125	1.128	0.432	0.73	1.19
180	722D187F200JJ1	1.000 x 1.625	0.560	0.216	1.20	1.93
270	722D277F200JL1	1.000 x 2.125	0.365	0.141	1.65	2.64
390	722D397F200JP1	1.000 x 2.625	0.278	0.108	2.06	3.29
470	722D477F200JS1	1.000 x 3.125	0.221	0.087	2.49	3.97
560	722D567F200JT1	1.000 x 3.625	0.183	0.072	2.91	4.63
250 VOLTS DC WORKING; 300 VOLTS DC SURGE						
27	722D276F250GE1	0.750 x 1.125	3.614	1.449	0.34	0.54
56	722D566F250GJ1	0.750 x 1.625	1.721	0.691	0.57	0.90
100	722D107F250GL1	0.750 x 2.125	1.130	0.454	0.79	1.25
120	722D127F250GP1	0.750 x 2.625	0.880	0.354	0.98	1.55
150	722D157F250GS1	0.750 x 3.125	0.690	0.278	1.20	1.88
180	722D187F250GT1	0.750 x 3.625	0.568	0.230	1.41	2.22
47	722D476F250HE1	0.875 x 1.125	2.369	0.953	0.47	0.74
100	722D107F250HJ1	0.875 x 1.625	1.148	0.463	0.77	1.21
150	722D157F250HL1	0.875 x 2.125	0.753	0.304	1.06	1.67
180	722D187F250HP1	0.875 x 2.625	0.574	0.232	1.33	2.08
220	722D227F250HS1	0.875 x 3.125	0.464	0.188	1.59	2.50
270	722D277F250HT1	0.875 x 3.625	0.375	0.153	1.89	2.96
56	722D566F250JE1	1.000 x 1.125	1.708	0.689	0.60	0.94
120	722D127F250JJ1	1.000 x 1.625	0.829	0.336	0.98	1.54
180	722D187F250JL1	1.000 x 2.125	0.548	0.223	1.34	2.11
270	722D277F250JP1	1.000 x 2.625	0.410	0.167	1.69	2.65
330	722D337F250JS1	1.000 x 3.125	0.328	0.134	2.04	3.18
390	722D397F250JT1	1.000 x 3.625	0.274	0.112	2.38	3.71

722D/723D TYPICAL PERFORMANCE PROFILES

TEMPERATURE CHARACTERISTICS

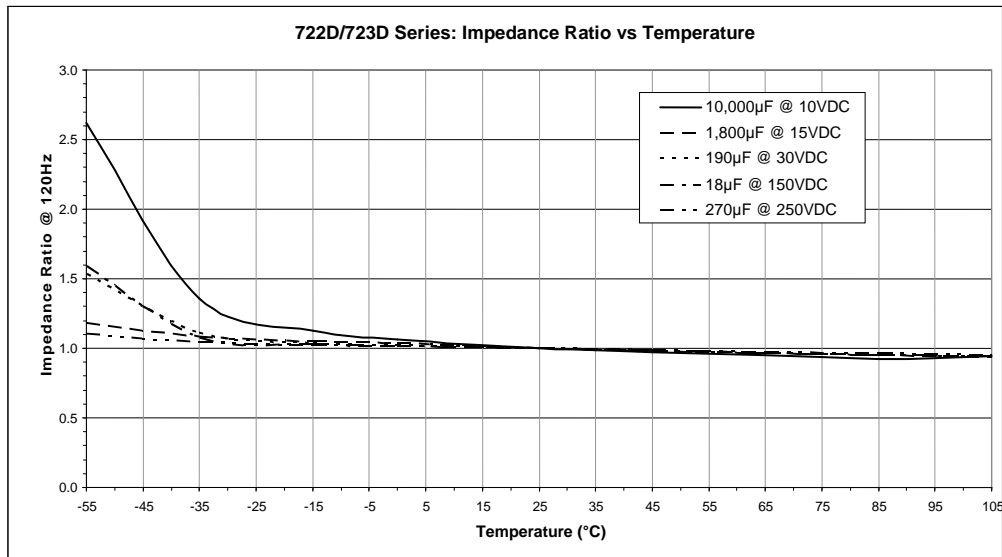
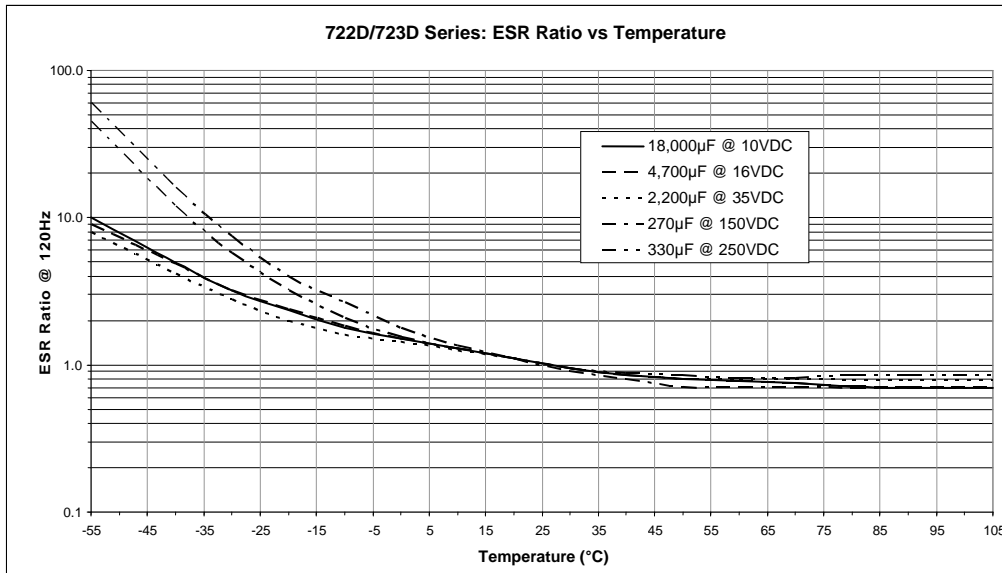
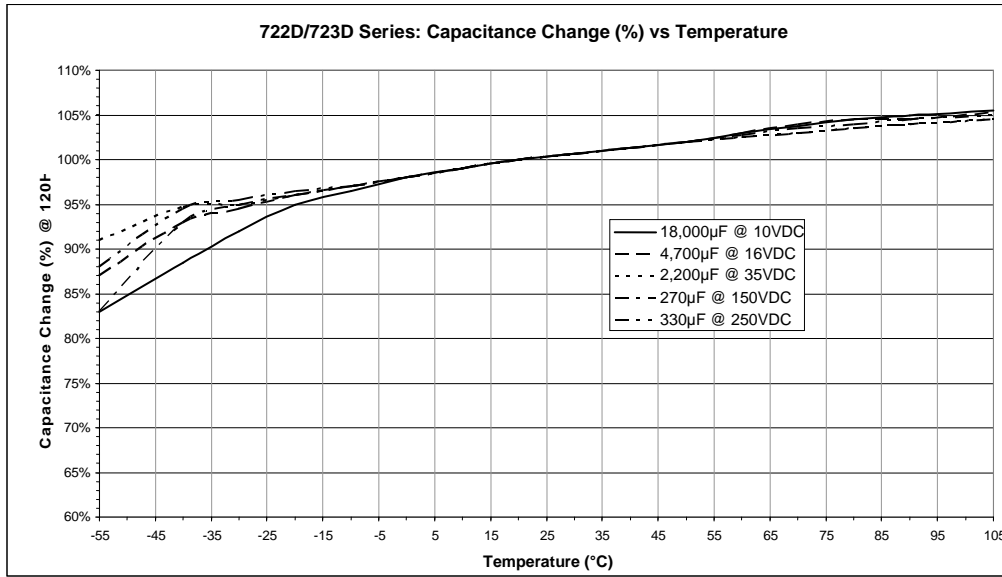

722D/723D TYPICAL PERFORMANCE PROFILES

FREQUENCY CHARACTERISTICS

